



Red Post Court, Peasedown St John, BA2 8LG

£240,000

- **NO ONWARD CHAIN**
- **PARKING**
- **Energy Rating - C**
- **Tenure - Freehold**
- **Prime Location**
- **Two Bed Terrace**
- **Enclosed Rear Garden**
- **Council Tax Band - B**
- **Close Commuting distance To The City Of Bath**
- **Ideal For First Time Buyer or Investors Alike**

Barons Property Centre is delighted to present this NO ONWARD CHAIN mid-terrace home with two double bedrooms, located in the peaceful cul-de-sac of Red Post Court.

The property offers a fitted kitchen and a bright, spacious lounge/diner, enhanced by patio doors that flood the room with natural light and open onto a private, low-maintenance rear garden. Upstairs, you'll find two well-proportioned bedrooms, with the master bedroom benefiting from fitted double wardrobes, alongside a family bathroom complete with a shower over the bath.

Additional highlights include double glazing, gas central heating, and valuable off-street parking for two vehicles. Offered with no onward chain, this is a fantastic opportunity for first-time buyers, downsizers, or investors seeking a hassle-free, move-in-ready home in a quiet yet convenient location.

Early viewing is highly recommended.

Kitchen 7'10" x 7'8" (2.40 x 2.36)

Lounge / Diner 16'5" x 11'7" (5.02 x 3.55)

Bedroom One 13'1".78'8" x 8'5" (4..24 x 2.59)

Bedroom Two 10'6" x 6'7" (3.21 x 2.01)

Bathroom 7'6" x 4'9" (2.31 x 1.45)





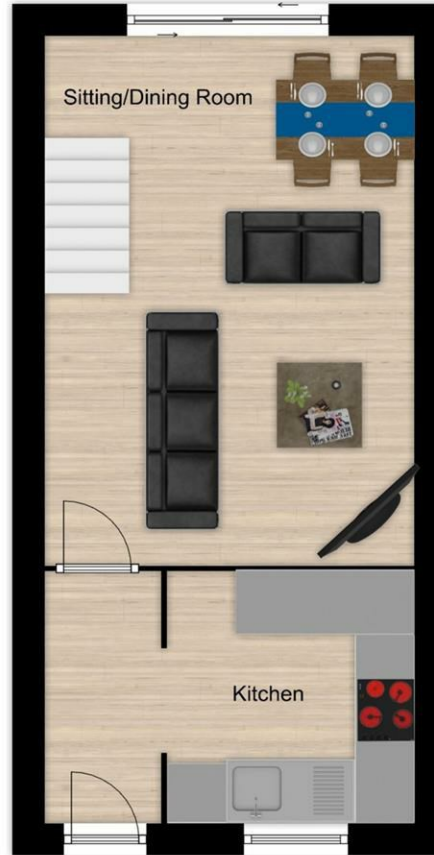

© Greenwood's Barons Property Centre 2026

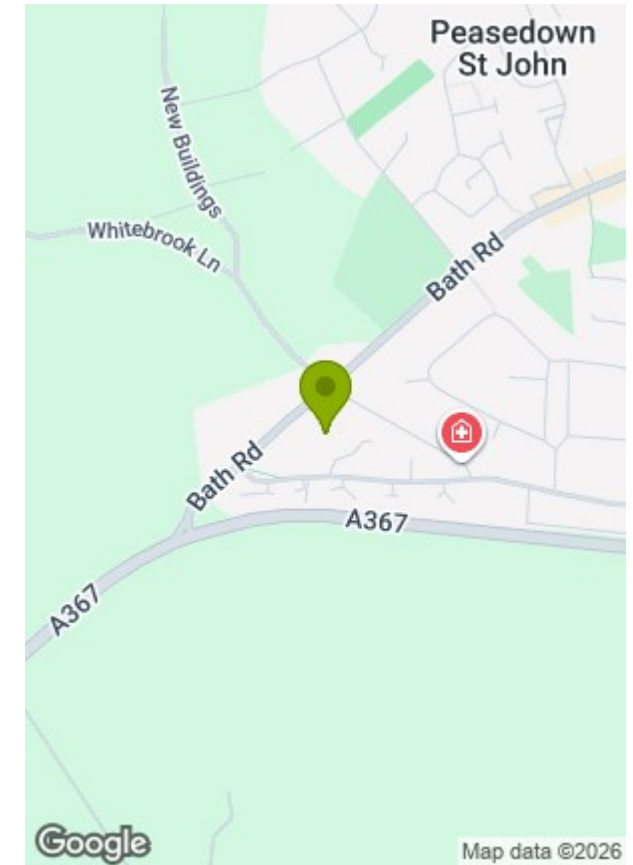

Energy Efficiency Rating		
	Current	Potential
Very energy efficient - lower running costs		
(92 plus) A		
(81-91) B		
(69-80) C		
(55-68) D		
(39-54) E		
(21-38) F		
(1-20) G		
		88
	71	
Not energy efficient - higher running costs		
England & Wales EU Directive 2002/91/EC		

Environmental Impact (CO ₂) Rating		
	Current	Potential
Very environmentally friendly - lower CO ₂ emissions		
(92 plus) A		
(81-91) B		
(69-80) C		
(55-68) D		
(39-54) E		
(21-38) F		
(1-20) G		
Not environmentally friendly - higher CO ₂ emissions		
England & Wales EU Directive 2002/91/EC		

These particulars, whilst believed to be accurate are set out as a general outline only for guidance and do not constitute any part of an offer or contract. Intending purchasers should not rely on them as statements of representation of fact, but must satisfy themselves by inspection or otherwise as to their accuracy. No person in this firm's employment has the authority to make or give any representation or warranty in respect of the property.